

# ENDON®

## Calla 8lt Pendant Light Fitting INSTRUCTION MANUAL

### Safety Warnings

- This product is only suitable for connection to a 240V~50Hz supply in accordance with current IEE wiring regulations, and should be installed in accordance with local building regulations. It is for indoor use only, and is **not** suitable for a bathroom location.
- Before installing your light fitting always switch off the mains supply, and remove the appropriate fuse or switch off the appropriate circuit breaker before commencing installation. Ensure that no one else has access that would enable the supply to be inadvertently reconnected.
- This is a Class I product and **must** be connected to Earth. The terminal blocks are supplied according to requirements of the fitting.
- Never fit bulbs of a higher wattage than those specified on the label (as these may cause overheating and damage the fitting)
- This product may contain delicate parts – be careful during handling and maintenance to avoid breakage.
- If you are in any doubt about your competence please consult a qualified electrician.
- If any modification is made it will invalidate the warranty and may render the product unsafe.

### Care Information

Allow 10 minutes to cool before replacing, adjusting or cleaning.

Clean with a dry cloth only. Do not use liquid or abrasive cleaners on this product.

### Assembly/ User Instructions

#### Before you start

Please read these instructions carefully before fitting and retain for reference. Check the packaging and make sure that you have all the required parts. Follow each assembly step in order to prevent incorrect assembly. Ensure that the product is fully assembled as illustrated before use.

#### The light pack contains:

Light fitting.

Fixing pack

48 x Rods

69 x Crystals (29 x large, 40 x small)

#### The following tools may be required:

Selection of cross and flat head screwdrivers.

Electric drill and assorted drill bits.

Wire strippers.

**These assembly diagrams are intended as a guide – if in doubt consult a qualified electrician.**

1. Decide on the position of the light fitting or remove existing light fitting. Note the position of the electrical connections, and ensure there is a solid mounting surface, preferably a wooden joist or joist bridge, to support the weight of the light fitting.

2. If you want to reduce the overall length of the fitting, this will be easier to complete before attaching the product to the ceiling. To reduce the drop of this pendant, push the steel cable up into the ceiling cover. To increase the drop press button X. To reduce the length of the electrical flex, pull the flex through the cable grip Y in the ceiling cover. Always ensure the weight of the product is supported by the steel cable and not the electrical flex.

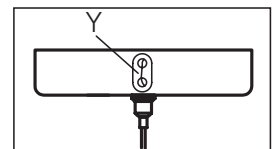
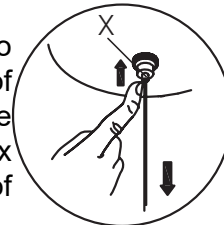

3. Remove the two side screws (E) and retain for re-use. Use the fixing bracket (F) as a template to mark the screw holes. Make the screw holes and secure to the ceiling with appropriate fixings (G).

4. Support your fitting and connect the house wiring to the terminal block – see expanded wiring details below (H).

**NOTE: This is a Class I fitting and must be earthed.**

5. Re-fit the product to the fixing bracket using side screws, tighten to secure. Take care to avoid damaging any concealed wiring and pipes. Do not overtighten.



# Assembly/ User Instructions Continued

6. Fit the bulbs (I). **NOTE: Never fit bulbs of a higher wattage than those specified on the label, as these may cause overheating and damage the fitting.**
7. Screw the rods (A-D inclusive) into the central boss (J). See below for details of sizes and positioning.
8. Hook the crystals (K/L) onto the rods.
9. Turn on the power and test.

